

# Electromagnetic Lock Installation Instruction Guide (Intend for use in indoor dry location)

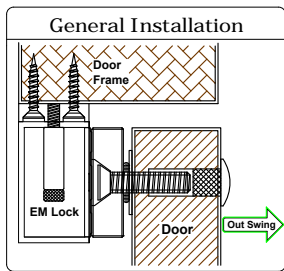

Model	300D-S
Spec	
Holding Force	Up to 300 lbs x2 (Factory Tested)**
Voltage Input	12VDC / 24VDC *
Current Draw	300mA x 2 / 150mA x2
Dimension	(L)340 x (W)35 x (T)22 (mm)

## Basic Installation Concept & Accessories



T Handle Allen Key

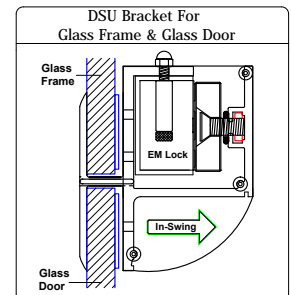
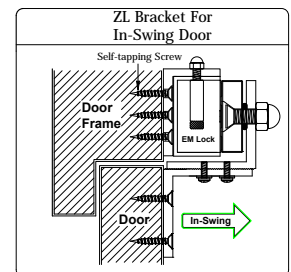
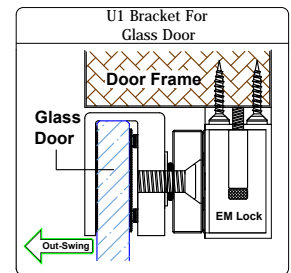
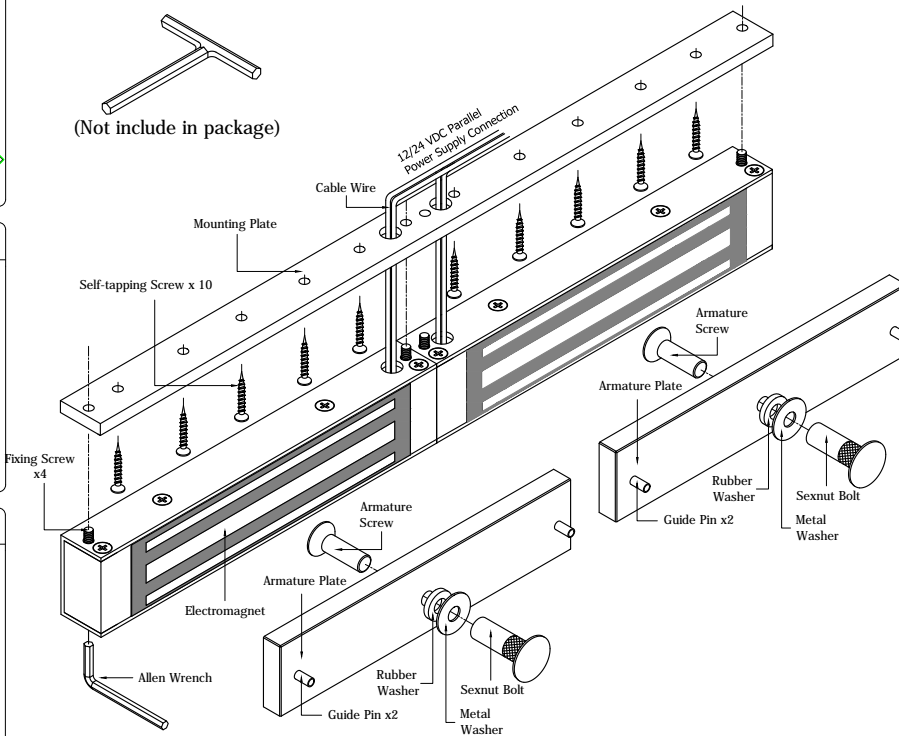
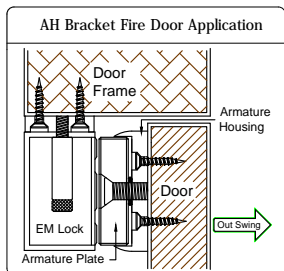
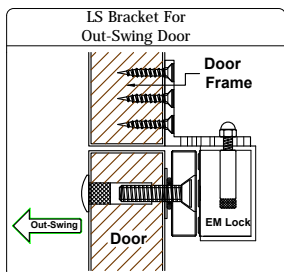
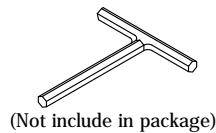

## General Installation Steps & Maintenance

1. Fold the installation template provided along the dotted line upto 90°.
2. Close the door & position the template at the lock jamb side of the frame with a gap 10mm.
3. Mark & drill holes according to template indications.
4. Install the Armature Plate to the door.
5. Loosely tighten screw through the adjustable slot on mounting plate to the door frame as indicated on installation template.
6. Make sure the mounting plate & armature align properly, then screw in the balance mounting screws.
7. Use allen wrench to unscrew anti tamper nut and install the lock by tighten the fixing screws on the mounting plate. Pull cable wire through frame to lock housing.
8. Screw in the anti-tamper nuts to prevent unauthorized access and make sure to fully tighten the fixing screw with proper tool "T" Handle Allen Key.
9. Connect the power wires accordance with NFPA 101 & all wiring to be completed inside protect area.
10. Typical wiring method which shall be in accordance with CSA C22.1, Canadian Electrical Code, Part I, Safety Standard for Electrical Installations, Section 32.
11. It is recommended that to apply a light coat of silicon lubricant to the mating surface on a monthly basis to prevent rust.

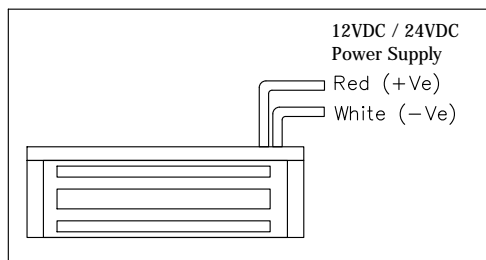

## Wiring Instruction

\* Note: 12VDC / 24VDC is pre-set upon manufacture; once it set, it cannot be changed.

Notice:  
Model are Recognized to:  
UL 294 : Standard for Access Control System Units, 6th Ed.  
ULC S533-15: Standard for Egress Door Securing & Releasing Devices, 4th Ed.

\*\* Value not verified by UL.

Remark: All drawing shown are for illustration purpose only.  
Actual product may vary due to product enhancement.

## Trouble Shooting

1. Sensor not functioning
  - Improper attachment of electromagnet and armature plate
  - Modification of the PCB
2. Door not locked
  - Incorrect wiring or no power from power supply
3. Reduced holding force
  - Poor contact of electromagnet and armature.
  - Be sure armature is loose enough that it can fully contact electromagnet along the entire length.
  - Mating surface is dusty or damaged.
  - Improper input voltage or wire size.

## Performance Level

- Destructive Attack: Level I
- Line Security: Level I
- Standby Power: Level I
- Endurance 250,000 Cycles: Level IV (Relay Source #2 & #3)

Copyright © E.I.S.B. All Right Reserved.  
EISB-EMS-IG Ver.A Publish:06.3.2020